

## **ATTACHMENT F**

**RELEVANT KEY MAPS  
FROM PLANNING PROPOSAL  
SYDNEY LOCAL ENVIRONMENTAL PLAN  
2010 (GREEN SQUARE TOWN CENTRE)  
AND DRAFT GREEN SQUARE TOWN  
CENTRE DEVELOPMENT CONTROL  
PLAN 2012**

# ATTACHMENT F

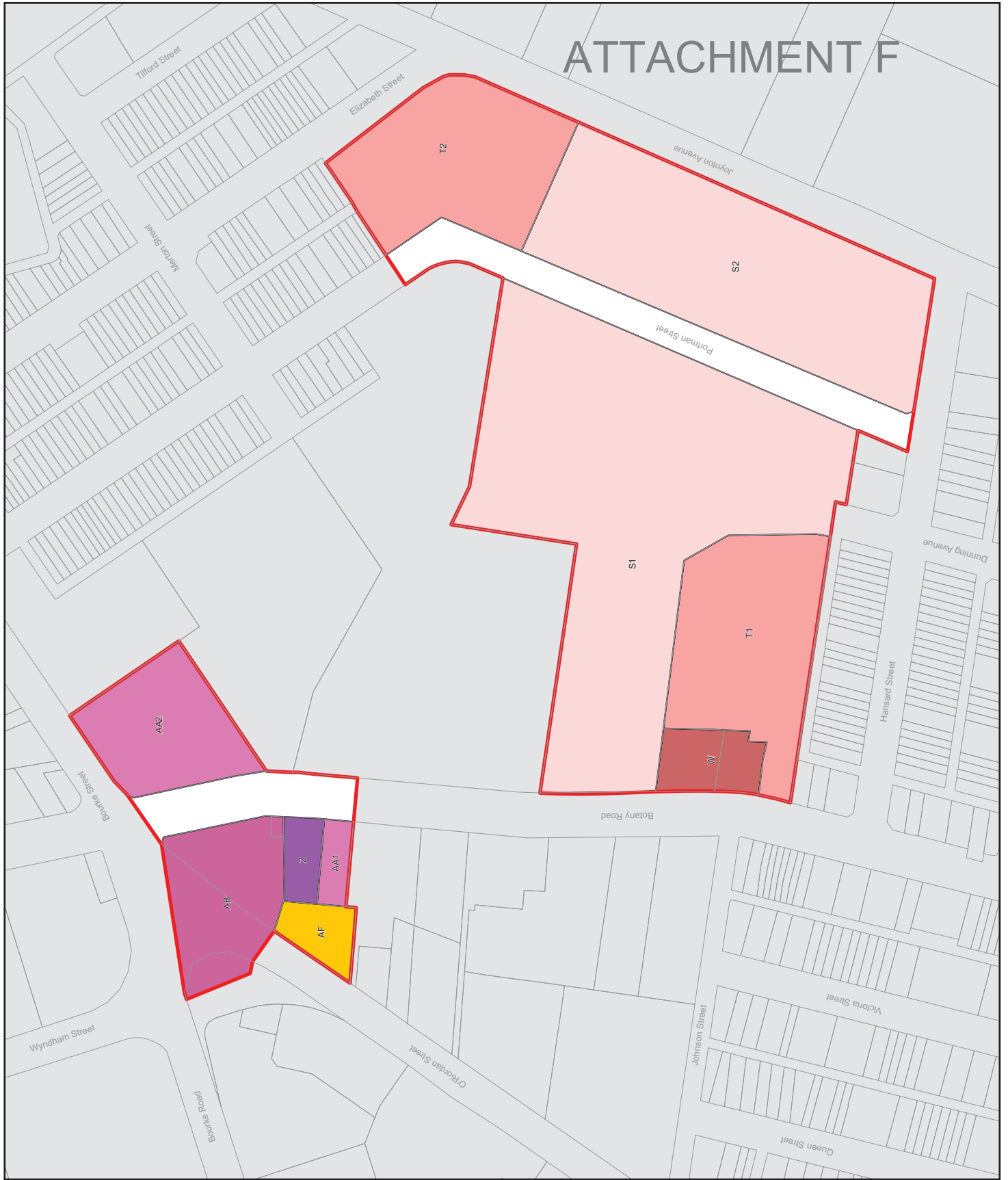

**Sydney Local Environmental Plan 2010 (Green Square Town Centre) Sites**  
 2A Bourke Road,  
 6-12 O'Riordan Street,  
 301-303 Botany Road,  
 312-318 Botany Road,  
 318A Botany Road,  
 320-322 Botany Road,  
 324 Botany Road,  
 501 Botany Road,  
 509 Botany Road,  
 511-515 Botany Road,  
 97-115 Portman Street,  
 811 Elizabeth Street,  
 3 Joynton Avenue

## Floor Space Ratio Map

Maximum Floor Space Ratio (n:1)

S1	1.81
S2	1.86
T1	2.16
T2	2.31
W	3.64
Z	5.56
AA2	6.28
AA1	6.35
AB	7.64
AF	11.54

**Cadastral**

□ Cadastral 2001/2012 © City of Sydney

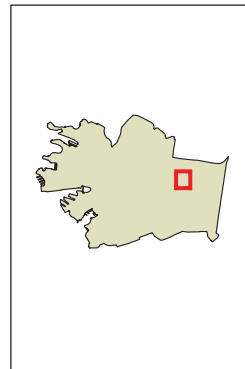

Projection: GDA 1984  
 Zone 56

Map identification number:  
 7200\_HP\_L2M\_001\_20120220

# ATTACHMENT F

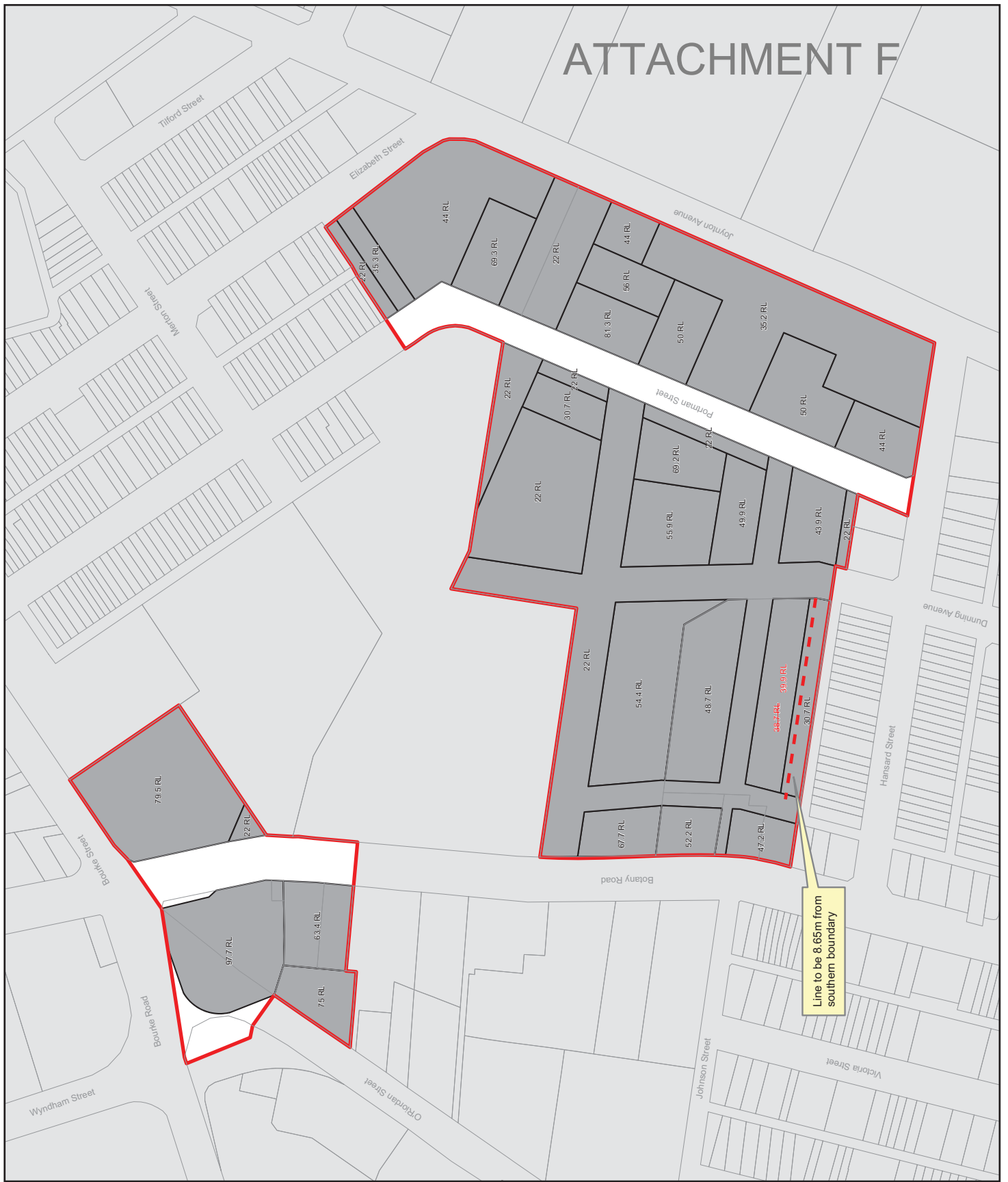

**Sydney Local Environmental Plan 2010 (Green Square Town Centre) Sites**  
 2A Bourke Road,  
 6-12 O'Riordan Street,  
 301-303 Botany Road,  
 312-318 Botany Road,  
 318A Botany Road,  
 320-322 Botany Road,  
 324 Botany Road,  
 501 Botany Road,  
 509 Botany Road,  
 511-515 Botany Road,  
 97-115 Portman Street,  
 811 Elizabeth Street,  
 3 Joynton Avenue

## Height of Building Map

Maximum Height of Building (m)

Specific RLs

Cadastral

Cadastral 17/02/2012 © City of Sydney

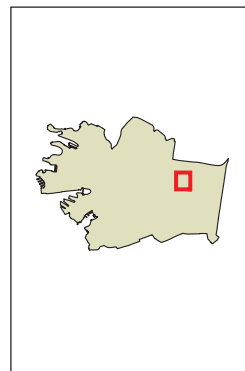

Projection: GDA 1994  
 Zone 56

Scale: 1:3,000 @ A4

Map identification number:  
 7200\_HP\_L2M\_001\_20120217

# ATTACHMENT F

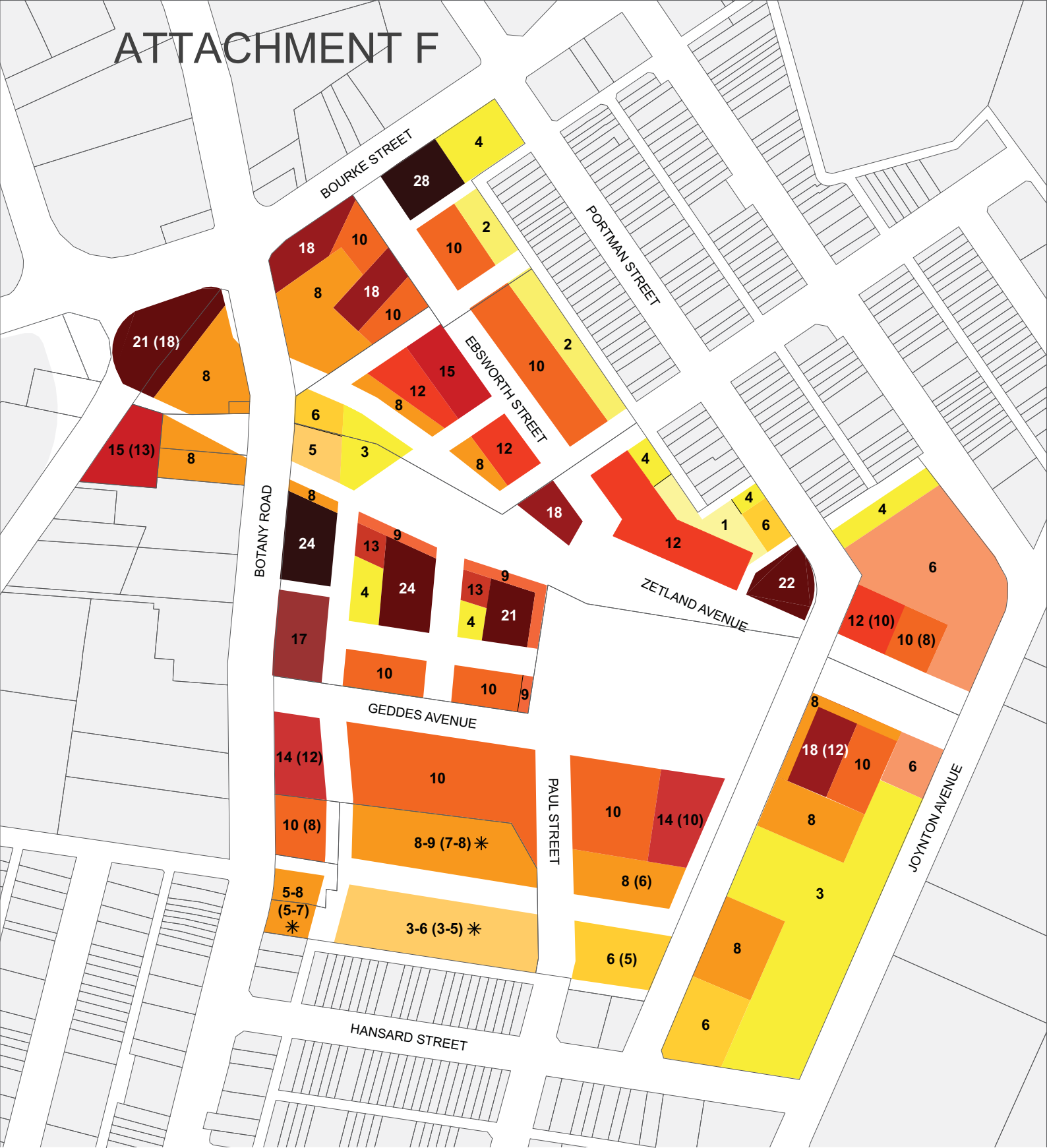

## KEY

**X** Maximum building height in storeys **including** additional floor space available through competitive design process (where applicable)

**(X)** Maximum building height in storeys **excluding** additional floor space available through competitive design process - shown in brackets

\* Heights subject to development meeting minimum sun access requirements to adjacent private open space as per GSTC DCP clause 6.10.2. Refer to building envelope diagram.

# ATTACHMENT F

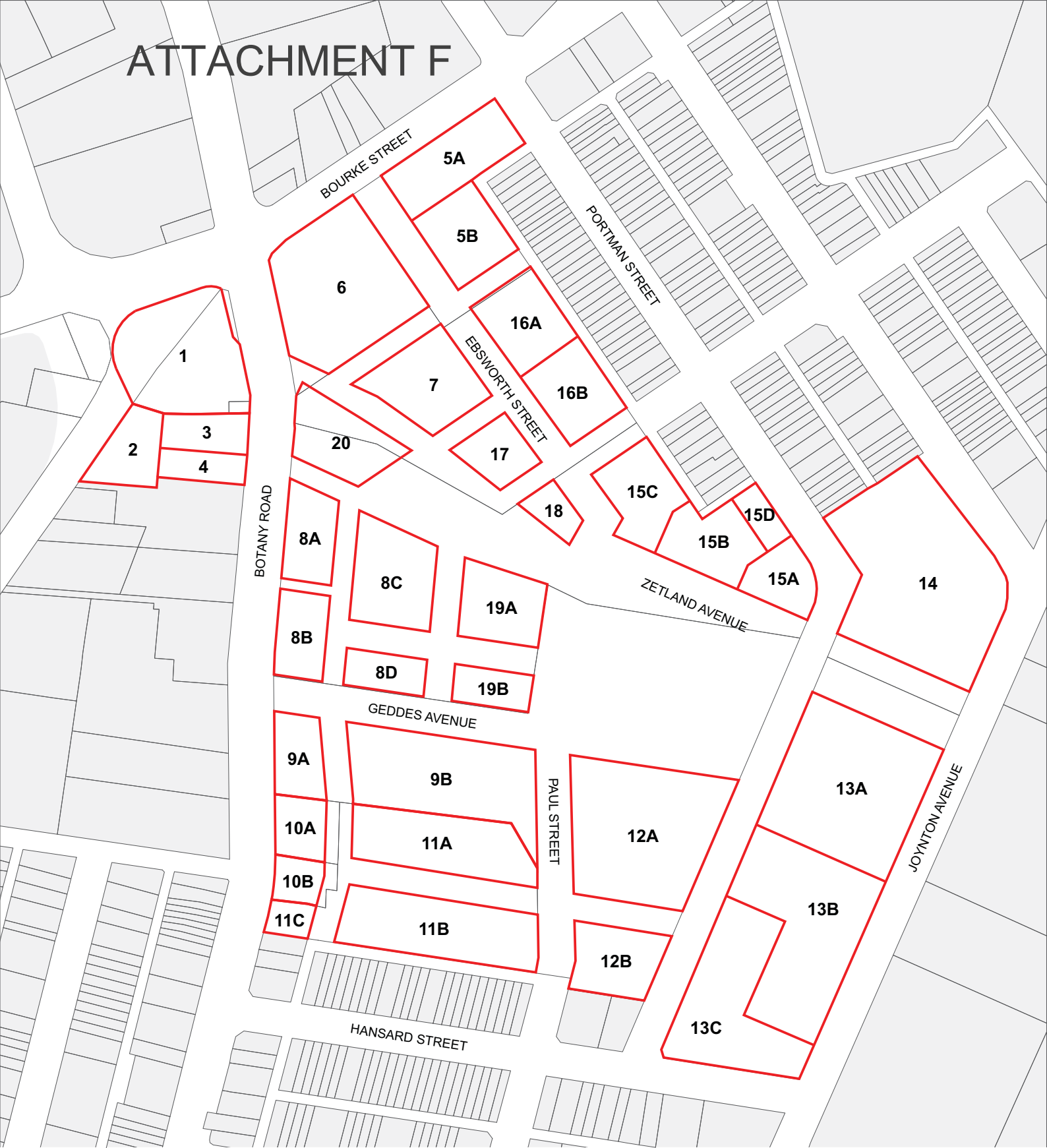

## KEY

- X Development sites (name)
- Existing lot boundaries